

Global warming of 1.5°C

An IPCC Special Report on the impacts of global warming of 1.5°C above pre-industrial levels and related global greenhouse gas emission pathways, in the context of strengthening the global response to the threat of climate change, sustainable development, and efforts to eradicate poverty

Second Lead Author Meeting

ROOM ASSIGNMENT UK MET OFFICE – DAY 1

Activity	Room name	Floor
Plenary	Conference 1 & 2	Second
Chapter 1 meetings	FG4	Ground
Chapter 2 meetings	C2 1&2	Second
Chapter 3 meetings	C1 1&2	First
Chapter 4 meetings	Conference 3 & 4	Second
Chapter 5 meetings	FG5	Ground
CLA / Co Chair meetings	Conference 3 & 4	Second
Coffee break morning	Balcony	Second
Lunch	Balcony	Second
Coffee break afternoon	Street	Ground
Help desk	Street	Ground
TSU office	CG1 and CG2 (TBC)	Ground
Co Chair office	FG6	Ground
Vice Chair meeting office	FG2 and FG3	Ground
Co Chair talks	Conference 1 & 2	Second
Evening Reception	Street	Ground

Global warming of 1.5°C

An IPCC Special Report on the impacts of global warming of 1.5°C above pre-industrial levels and related global greenhouse gas emission pathways, in the context of strengthening the global response to the threat of climate change, sustainable development, and efforts to eradicate poverty

Second Lead Author Meeting

ROOM ASSIGNMENT UNIVERSITY – DAYS 2 TO 5

Activity	Room name	Building	Floor
Plenary	Henderson Lecture Theatre	XFi	Ground
Chapter 1 meetings	Seminar Room B	XFi	Ground
Chapter 2 meetings	Seminar Room C	XFi	Ground
Chapter 3 meetings	Conference Room 1	XFi	Ground
Chapter 4 meetings	Conference Room 2	XFi	Ground
Chapter 5 meetings	Seminar Room A	XFi	Ground
Cross chapter meetings (1)	Bateman Lecture Theatre	Building One	First
Cross chapter meetings (2)	Henderson Lecture Theatre	XFi	Ground
Cross chapter meetings (3)	Streatham Court	Streatham Court	Ground
CLA / Co Chair meetings	Bateman	Building One	First
SPM Meeting (Friday PM)	Bateman	Building One	First
SPM Meeting (Saturday AM)	Lounge Terrace	Southgate Hotel	Ground
Press briefing	Henderson Lecture Theatre	XFi	Ground
Coffee breaks	Atrium	XFi	Ground
Lunches	Atrium	XFi	Ground
Help desk	Next to Atrium & Main Entrance	XFi	Ground
TSU office	Streatham Court	Streatham Court	Ground
Co Chair office	Board Room	XFi	Ground
Vice Chair meeting office	Kolade	Building One	Second

University of Exeter – Floor Map Buildings XFi and One

Building One

XFi Building

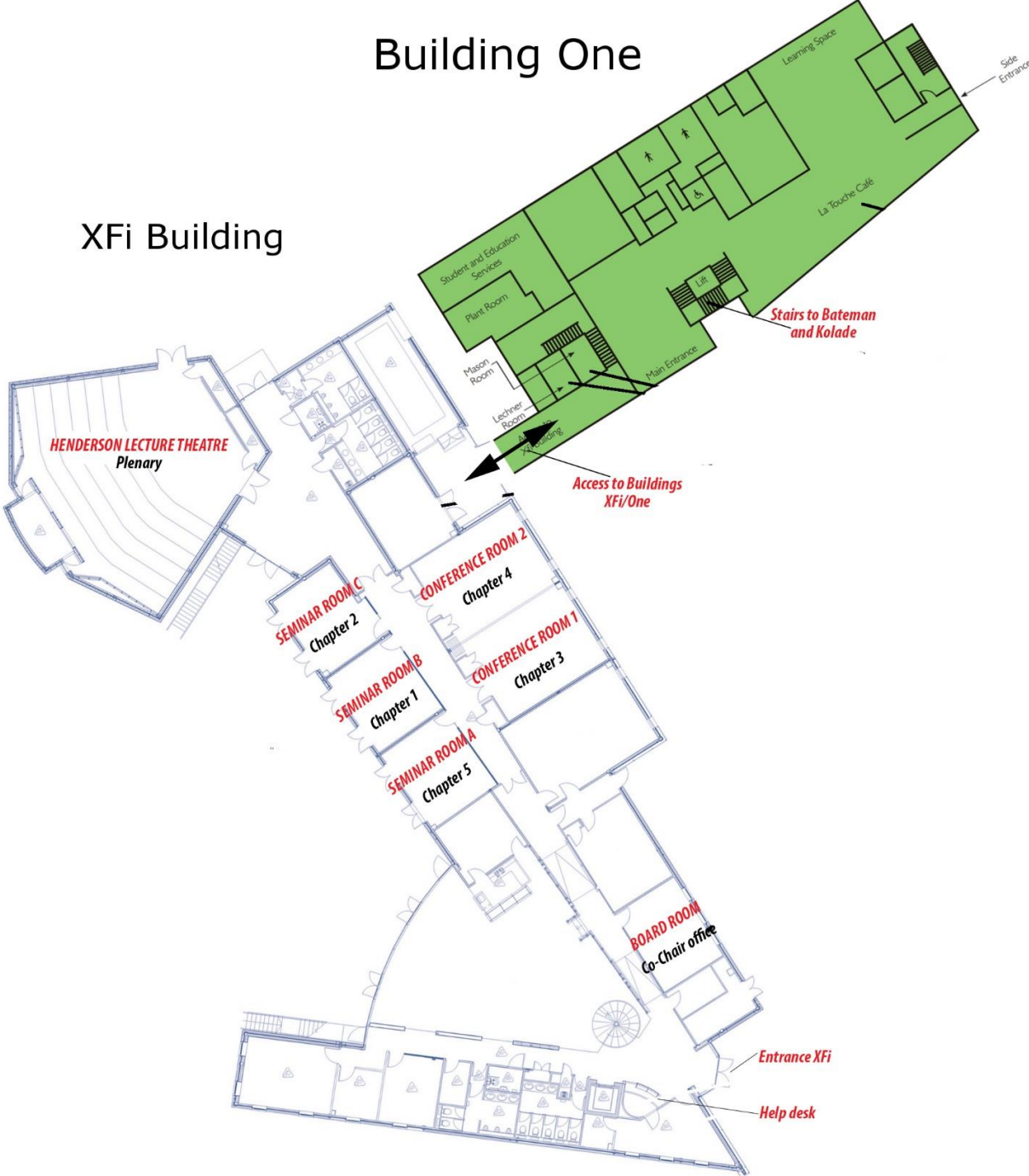



Henderson Lecture Theatre

XFi Building
Ground Floor



Conference Rooms 1 & 2

XFi Building
Ground Floor



Seminar Rooms A, B & C

XFi Building
Ground Floor



Board Room

XFi Building
Ground Floor



Bateman Lecture Theatre
Building One
1st Floor



Kolade Teaching Room
Building One
2nd Floor



Room SC028
Streatham Court
Ground Floor